

Chemical Storage Rack

Assembly and Installation Instructions

LEGEND BRANDS, INC.

15180 Josh Wilson Road, Burlington, WA 98233

Phone: 800-932-3030 Fax: 360-757-7950 www.LegendBrandsRestoration.com

The Chemical Storage Rack provides convenient, secure storage for gallon bottles in work vans and other vehicles. Each shelf rotates independently, allowing easy access to shelf contents.

READ AND SAVE THESE INSTRUCTIONS

SAFETY INSTRUCTIONS

WARNING! Improper assembly and/or installation in a motor vehicle could result in heavy bottles shifting or coming off shelves while moving or when stopping suddenly. Follow instructions carefully and periodically recheck vehicle retention nuts and bolts for proper attachment.

WARNING! A broken or damaged unit can be hazardous in a motor vehicle. Periodically check unit for broken supports and loose fittings.

ASSEMBLY INSTRUCTIONS

Figure 1: Rack Assembly Parts

1. Plastic sleeve (12 pcs).
 2. Base bracket
 3. Base shelving rod
 4. Upper shelving rod
 5. Wire basket shelf (4 pcs)
 6. Spacer washer (8 pcs)
 7. Threaded rod.
 8. Bushing (4 pcs)
 - 9, 10, 11, 12: Shelving rod base bracket retaining bolt, 2 flat washers, lock washer, and nut.
- ALSO INCLUDED (See Fig. 5): 13, 14, 15, 16, 17. Top mounting hardware.**

Assembly

1. Attach Base Shelving Rod (3) to Upper Shelving Rod (4) with Threaded Rod (7).
2. Insert in sequence a spacer washer (6), a bushing (8) and a second spacer washer (6) over the upper shelving rod and slide all the way to the bottom of the base shelving rod.
3. Insert three Plastic Sleeves (1) over the shelving rod, and slide each one all the way to the bottom. The sleeves will stack up on each other, resting on top of the spacer washer.
4. Slide the first Wire Basket Shelf (5) on to the Shelving Rod, and slide it to the bottom over the plastic sleeves.

Fig. 1: Shelf Assembly Parts

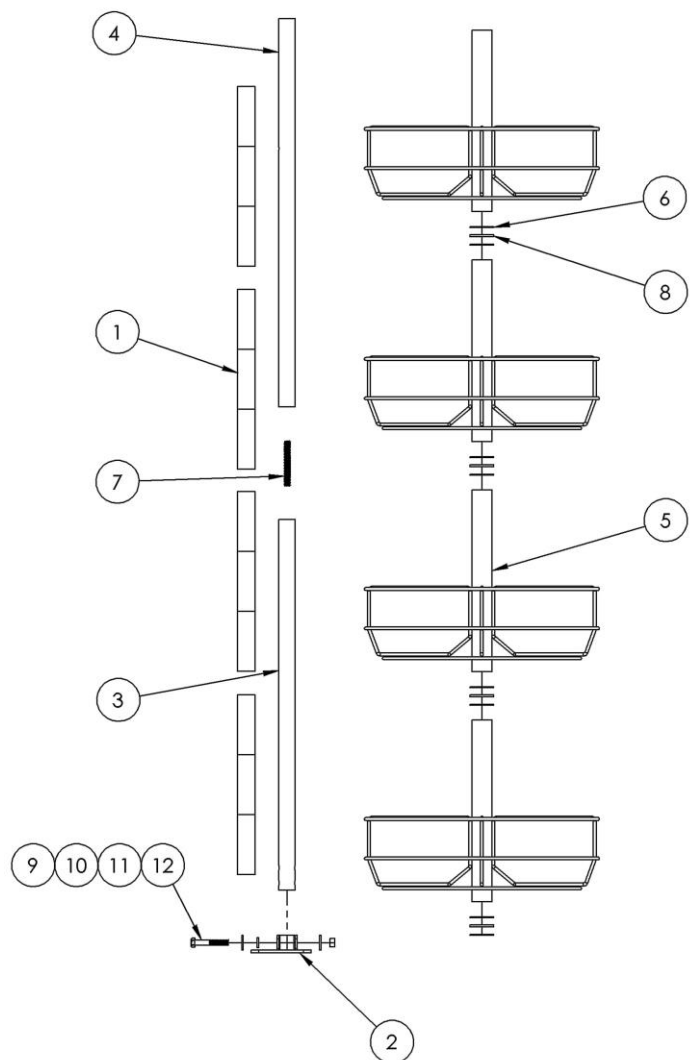

5. Repeat steps 3 through 5 to install the three remaining wire basket shelves.

VEHICLE INSTALLATION INSTRUCTIONS

1. Select a location in the vehicle where it will not interfere with doors or safety belts or obstruct the view of the driver.
2. Locate an appropriate location for mounting the top bracket.

NOTICE: Bracket *MUST* be attached to ceiling support beam (see Fig. 3). Attach bracket using 1/4" Tek screws or equivalent.

3. Use a plumb bob to determine the base bracket location. Make sure Shelving Rod is perpendicular to floor.

4. Attach base using hardware provided. Where possible, the bottom bracket should be attached with bolts that pass through the vehicle floor.

WARNING: Before drilling, inspect drilling locations carefully to ensure that you will not damage the fuel tank, fuel lines, or any other vital components which could affect the safety and or operation of the vehicle.

5. Assemble threaded rod (Fig. 5, no. 3) with washers and nuts as shown in Fig. 5. With nuts still loose, turn threaded rod up into top attachment bracket as far as possible.

6. Place the Rack in position. Insert the top threaded rod into the top of the Upper Shelving Rod (Fig. 5).

7. Secure the threaded rod by tightening the nuts (Fig. 5, no. 4) firmly against the Top Attachment Bracket and the Shelving Rod.

8. Slide the Rack into the base bracket (Fig. 1, no. 2) and secure using the provided hardware (Fig. 1, nos. 9, 10, 11, 12).

The Rack is now ready for use.

Fig. 3: Top attachment detail



Fig. 4: Top attachment bracket assembly

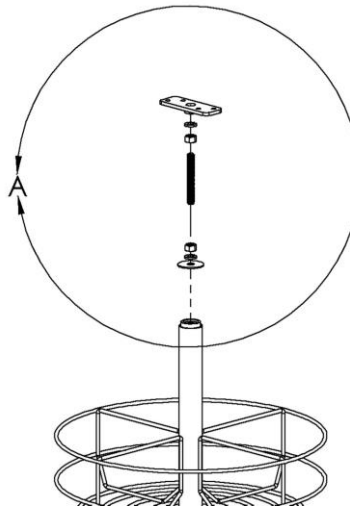
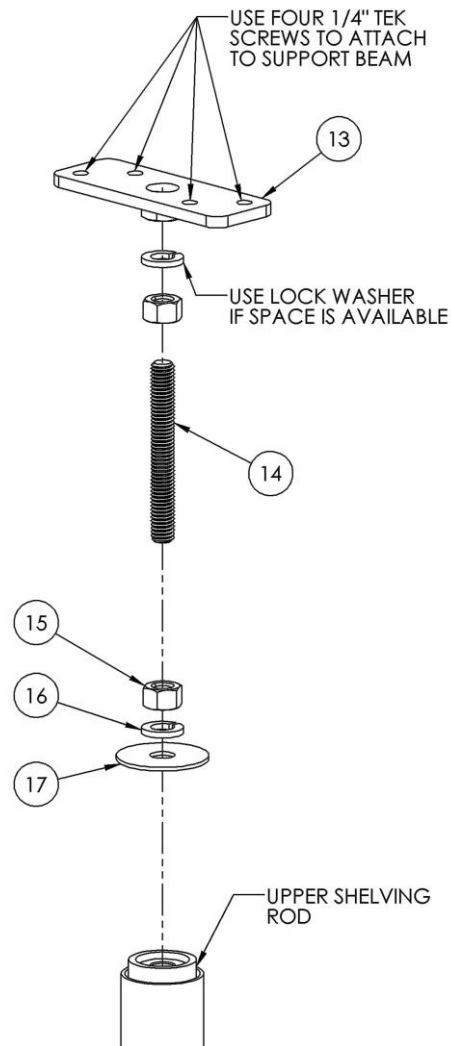

Fig. 5: Top attachment detail



WARRANTY

Sapphire Scientific provides the following warranty:

This warranty runs for ninety (90) days from the date of purchase on all parts.

If a defect in materials or workmanship occurs within the warranty period, Sapphire will replace the defective part at no charge.

This warranty does not cover or apply to defects due directly or indirectly to misuse, abuse, disassembly, alteration, corrosive chemicals, improper voltage, fire, flood, negligence, accident, improperly or incorrectly performed maintenance or repair, or if the use of this product is not in compliance with the instructions and specifications for its use.

OTHER THAN THE WARRANTIES PROVIDED HEREIN, SAPPHIRE MAKES NO EXPRESS OR IMPLIED, ORAL OR WRITTEN WARRANTIES WITH RESPECT TO THIS PRODUCT OR WORKMANSHIP AND ALL WARRANTIES IMPLIED BY LAW INCLUDING ANY WARRANTIES OF MERCHANTABILITY OR FITNESS FOR A PARTICULAR PURPOSE ARE LIMITED TO THE DURATION OF THIS WARRANTY. Some states do not allow limitations on how long an implied warranty lasts, so the above limitations may not apply to you. WE SHALL IN NO EVENT BE LIABLE FOR DEATH, INJURIES TO PERSONS OR PROPERTY OR FOR INCIDENTAL, CONTINGENT, SPECIAL OR CONSEQUENTIAL DAMAGES ARISING FROM USE OF OUR PRODUCTS. Some states do not allow the exclusion or limitation of incidental or consequential damages, so the above limitation or exclusion may not apply to you.

How Do I Get Service?

In order to be eligible for service under this warranty, write or call us for a return material authorization (RMA).

Have the serial number and original proof of purchase available.

We will inspect the product without charge and contact you within 72 hours of our receipt of the product to give you the results of our inspection. If our inspection uncovers a defect we will repair or replace the product, and pay for the cost of shipping it to Sapphire and the cost to return it to you.

If it is determined that there is no defect in the product, or that the defect resulted from causes not within the scope of our warranty, then the product will be replaced only at your request and at your expense and you must bear all costs of shipping and storing the product.

How Does State Law Apply?

This warranty gives you specific legal rights, and you may also have other rights which vary from state to state.

Warranty registration

Visit warranty.LegendBrandsCleaning.com to register your purchase. Registration allows us to better assist you with using, maintaining or servicing your equipment, as well as to contact you in case we have important safety information concerning your Sapphire Scientific product. If you determine service is required, have your equipment model, serial number and original proof of purchase available and call your distributor for assistance with obtaining a return material authorization (RMA).

CONTACT

LEGEND BRANDS, INC.

15180 Josh Wilson Road, Burlington, WA 98233
Phone: 800-932-3030 Fax: 360-757-7950
www.LegendBrandsRestoration.com



WARNING: This product and other substances that may become airborne from its use contain chemicals, including lead, known to the State of California to cause cancer, birth defects, or other reproductive harm. For more information, go to P65Warnings.ca.gov